

8 7 6 5 4 3

DATE	REV	NO.	DESCRIPTION	REV	NO.	DATE
09-09-01	1					

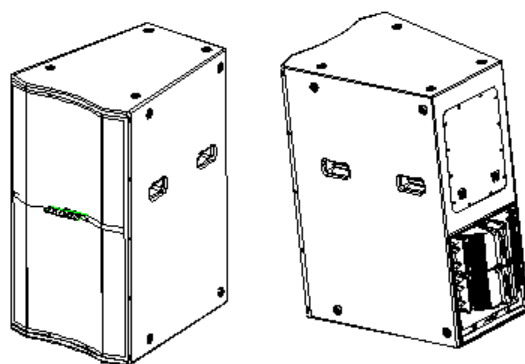
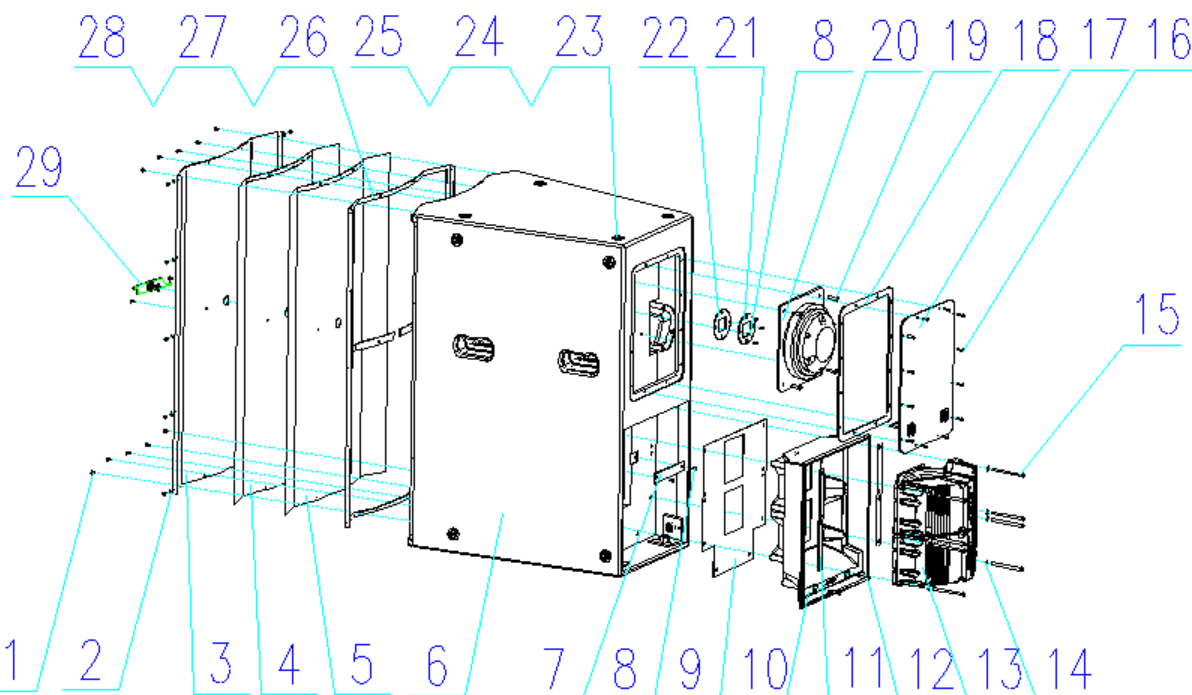

## NOTES:

1. MATERIAL: SEE BOM
2. FINISH: N/A
3. COSMETIC AND ACOUSTIC TESTING PER BOSE TEST SPECIFICATION TSXXXXXX
4. PRODUCT VALIDATED: PER BOSE VALIDATION PLAN VPXXXXXX
5. CONTROL CHARACTERISTICS (C) TO BE PER BOSE OPERATING PROCEDURE OP148887.

## BOSE/LT4402-WR/BLA BOM

## Speaker BOM

#	Elder Part No.	DWG. Title	Specification	DWG.	Qty	BOSE Part No.
1	B-L84-08	screw	Ty7*4*12mm/A/stainless/black	LT9702-II-117	2pcs	
2	4-L80-01	washer	flat washer4*9*0.8	149CS		
3	B-MWW-SMG03	grill	BOSELT4402-WR/Stainless/BLK	LT4402-II-116	1pcs	
4	B-NYM-05	foam	TA 826mm*480mm*4.5mm		1pcs	
5		cloth	826mm*480mm		1pcs	
6	B7-KTKQLW-SMG73	Cabinet	BOSELT4402-WR/PLY		1pcs	
7	B-YXP1-10	plate dividing	LT9702-II-140*23.8*3mm	LT9702-II-103	1pcs	
8	B-L84-03	screw	Ky7.8*4*12mm/A/BLK	LT9702-II-106	6pcs	
9	B-EVA-04	EVA gasket	V2 Cover EVA gasket 351*390*1/BLK		2pcs	
10	B-YXP1-24	V2 cover	LT9702-WR/377*310*104.5		1pcs	
11	B-DP-12	gasket	Rubber362*10*1/BLK		2pcs	
12	B-L84-01	screw	H/H6*30M/D=10/stainless black	LT9702-II-114	2pcs	
13	B7-YMZ1-02	Vee-2 assembly	V2 driver		2pcs	
14	B-DP-05	washer	Nylonφ12*φ6.6*1mm/BLK	LT9702-II-108	8pcs	
15	B-L83-01	screw	Ty13*6*90mm/M/BLK		8pcs	
16	B-L84-02	screw	Tyφ4*15mm/M/stainless/black	LT9702-II-119	1pcs	
17	B7-DZBZ1-SMG7	panel input Assy	BOSELT9702-WR		1pcs	
18	B-EVA-19	EVA gasket	349*246*2mm/adhesive single side	LT3302-II-115	1PCS	
19	B-L84-03	screw	Ty13*6*30mm/M/stainless/black	LT9702-II-109	4pcs	
20	B7-YMZ1-01	comp driver Assy	BOSE T1-1hp compression driver		1pcs	
21	B-YXP1-04	disk alignment comp driver	LT9702-II-φ75.4*2.5mm	LT9702-II-105	1pcs	
22	B-EVA-16	EVA gasket	φ75.4*φ7.5*1.5mm/adhesive single side	LT9702-II-106	1pcs	
23	B-L80-01	insert gasket 38-16 steel	φ30*φ114*19.5*35mm stainless	LT9702-II-103	1pcs	
24	B-L80-02	screw	CHφ17.4*9.5*3mm/M/stainless/black	LT9702-II-109	1pcs	
25	4-DP-09	washer	PVC washerφ15.5*φ9.6*0.4mm		1pcs	
26	B-EVA-19	EVA gasket	458*111*1.5mm/adhesive single side	LT4402-II-126	2pcs	
27	B-EVA-14	EVA gasket	216.5*151*1.5mm/adhesive single side	LT4402-II-127	2pcs	
28	B-EVA-19	EVA gasket	825.5*241*1.5mm/adhesive single side	LT4402-II-128	2pcs	
29	B7-BPZ1-SMG01	logo kits	BOSE/BLK		1pcs	

THIRD ANGLE PROJECTION	LEVEL	DATE	09-09-01
3	ENGINEER	09-09-01	DESCRIPTION
2	ENGINEER	09-09-01	ASSY LOUD SPKR, LT4402-WR, LTFR
1	REL FOR PROD PER	09-09-01	SCALE
1	REL FOR PROD PER	09-09-01	SCALE